

Synergy 21 LED Retrofit GX5,3 4W RGB-WW lamp with RF and WLAN *Milight/Miboxer*

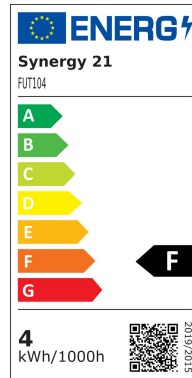

kwh/1000h:	4,00
Lumens:	280
Watt:	4,0
Nominal Service Life:	35000 Std.
Switching Cycles:	50000
Opt. Ambient Temperature.:	25 °C



Experience the flexible and modern lighting solution with the **4W MR16 RGB+CCT LED spotlight**. This innovative light source gives you the opportunity to customise the lighting to suit your needs and create the perfect atmosphere.

The **Spotlight** can be controlled with a **radio remote control** and a **WLAN controller for iOS and Android**, both available separately. These control options allow convenient and flexible customisation of the lighting to create the perfect mood for any occasion.

With an output of **4W** and a light output of **280 lumens**, this spotlight provides efficient and bright illumination. The variable colour temperature from **2700K to 6500K** and the RGB+CCT function allow you to choose both warm and cool whites as well as a wide range of colours. The **light efficiency of 70LM/W** and a **colour rendering index (CRI) of over 80** ensure a natural and vivid colour display.

The **LED spotlight** has a beam angle of **25°**, which ensures targeted and uniform light distribution. It is designed for a voltage of **AC/DC12V** and has a power factor of **0.55**, making it energy efficient. The robust construction made of **aluminium and PC** ensures a long service life and reliability. With a control range of up to **30 metres**, you can easily adjust the lighting from a distance.

This spotlight is perfect for accent lighting in living rooms, offices and other indoor areas. The easy installation and flexible control make it an ideal choice for anyone looking for a stylish and customisable lighting solution.

Experience the benefits of the **4W MR16 RGB+CCT LED spotlight** and improve the lighting in your rooms.

RGB-CCT GX5.3 light source

Controllable with wireless remote control and WLAN controller for iOS and Android, both available separately, see

accessories

Product Name: 4W MR16 RGB+CCT LED Spotlight

Model No: FUT104

Power: 4W

Voltage: AC/DC12V

Kelvin: 2700-6500K

Luminous Flux: 280LM

Luminous Efficiency: 70LM/W

CRI: >80

Base Type: MR16

Beam Angle: 25°

PF: >0.55

Material: Aluminium+PC

Control Distance: 30m

Size: 50*49mm

Energy Efficiency Class: F

kWh/1000h: 4

Attributes

Attribute	Value
Abstrahlwinkel:	25
CC oder CV:	CV
CRI:	80
Dimmbar:	Ja
Grösse:	50*49
LED - Gehäusematerial:	Aluminium
Lichtfarbe:	RGB-WW
Lichtfarbe in Kelvin:	2700~6500
Lumen:	280
Sockel:	GX5,3
Volt:	12
Weight:	0.1 Kg
Warranty:	24.00 Months

Additional Images

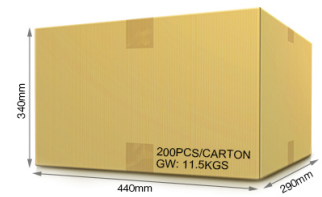
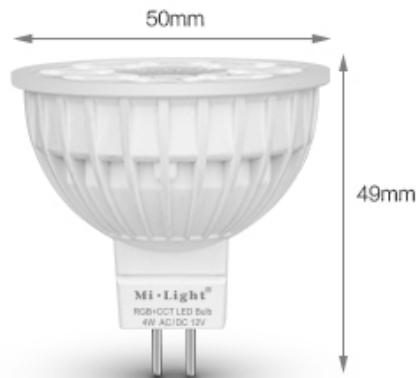

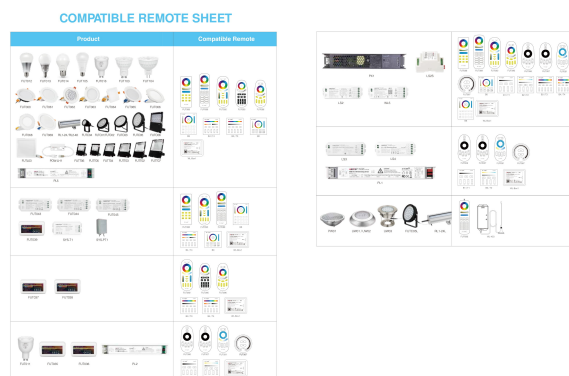
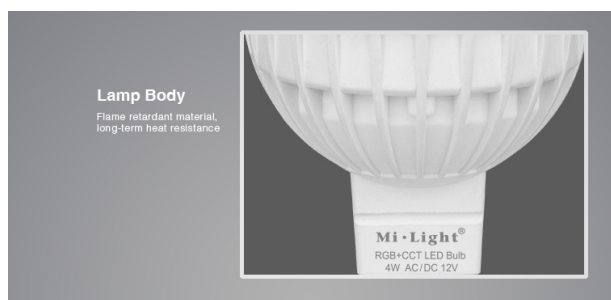

Accessories

Part No.	Name
147981	Synergy 21 LED remote RGB-WW (RGB-CCT) 8 zones *Milight/Miboxer*
147982	Synergy 21 LED remote RGB-WW (RGB-CCT) 4 zones *Milight/Miboxer*
148005	Synergy 21 LED remote smart panel RGB-WW (RGB-CCT) 4 zones *Milight/Miboxer*
148006	Synergy 21 LED remote smart panel RGB-WW (RGB-CCT) 8 zones *Milight/Miboxer*
181054	Synergy 21 LED remote WLAN controller *Milight/Miboxer*
148507	Synergy 21 LED remote WLAN controller smart light *Milight/Miboxer*

Part No.	Name
107727	HEP Power Supply - 12V 12W - HEP for Flush Mount Box