

## LC Duplex Adapter aqua, MM, without flange

Art.No.: 53516.1

Multimode LC/LC Duplex adapter, plastic housing aqua, ceramic sleeve, white dust cap.

### Specification

Sleeve Material	CERAMIC
Typical Insertion Loss, dB	0.1
Max Insertion Loss, dB	0.2
Durability(1000 Mating)	0.2dB Max.Increase
Operating Temperature, °C	-40 ~ +85
Storage Temperature, °C	-40 ~ +85

The performance of the adaptors has been carefully designed to meet the toughest Telcordia standards

### **GR-326-CORE**

### **RoHS-Compliance of item and package**

### **Conformance according to IEC 61754-20**

in the tests of:

- OPTICAL CHARACTERISTICS
- VIBRATION TEST
- THERMAL CYCLING
- IMPACT RESISTANCE
- SALT SPRAY EROSION
- THERMAL AGING
- HUMIDITY RESISTANCE
- OTHERS

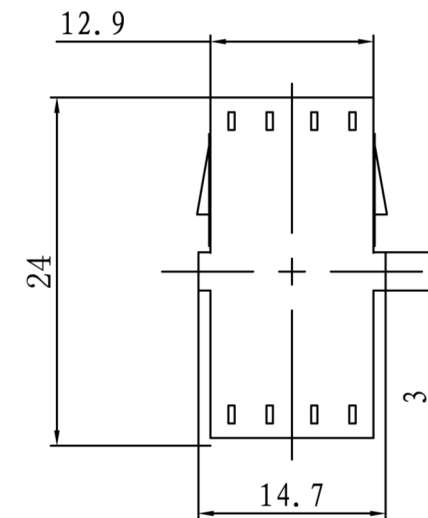
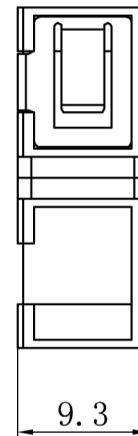
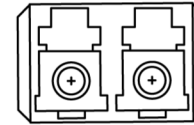

RoHS  
compliant

Created BT	Date 17.05.13	LC Duplex Adapter aqua, MM, without flange Art.No.: 53516.1	File: 53516.1.pdf
Last rev. BT	Date 17.05.13		